

SEZIONE ORIZZONTALE FINESTRA / PORTAFINESTRA 1 ANTA

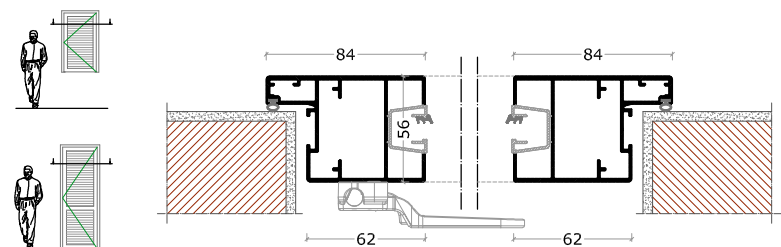

SEZIONE ORIZZONTALE FINESTRA / PORTAFINESTRA 2 ANTE

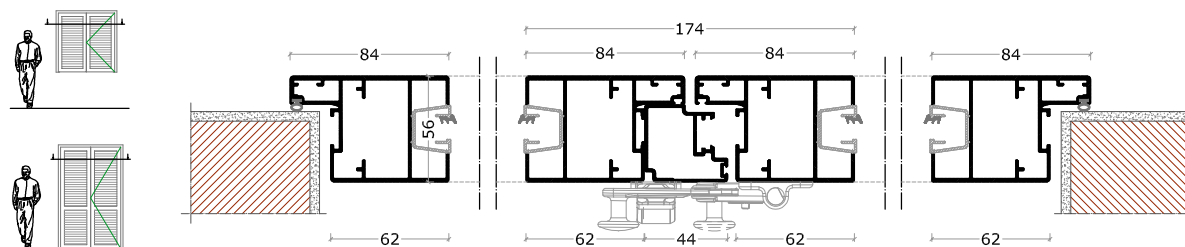

SEZIONE VERTICALE

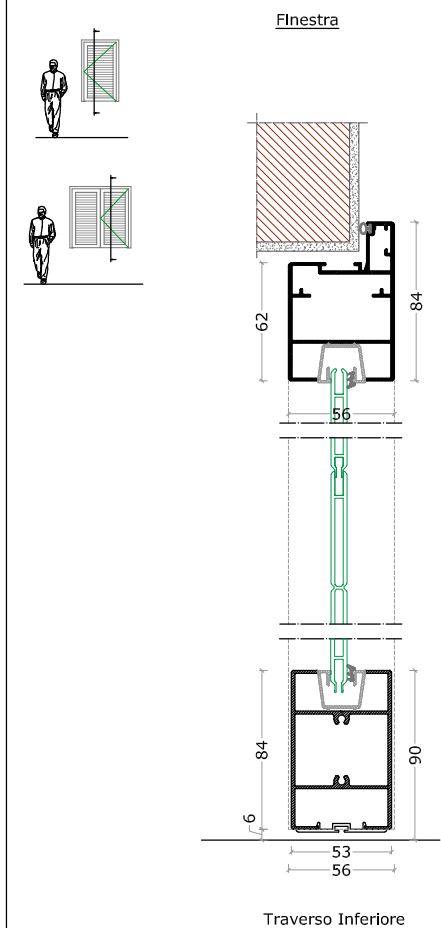

SEZIONE VERTICALE

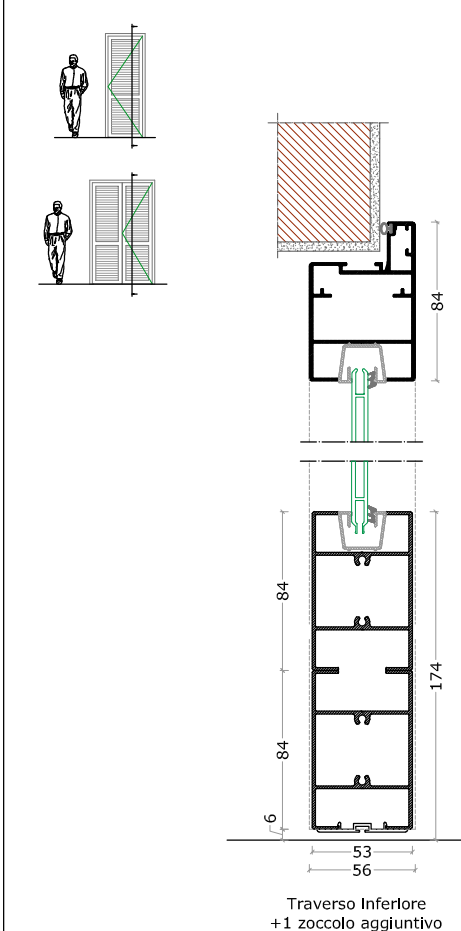

TRAVERSO ROMPIRATTA

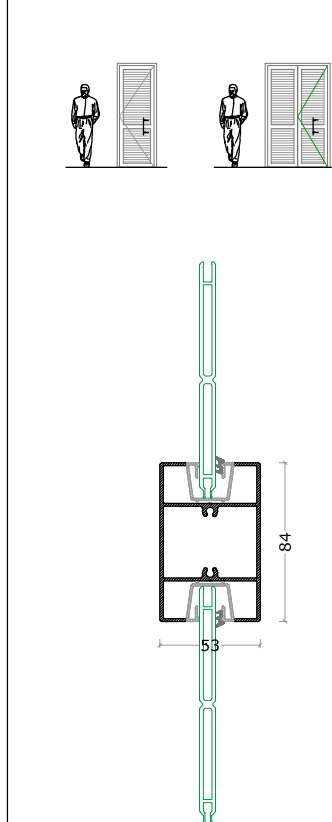

PARTICOLARI PANNELLO DOGATO

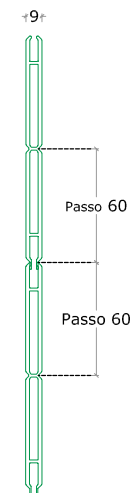

NOTE:

In base alle esigenze del cliente, le doghe possono essere sia in senso verticale, che in senso orizzontale.

SEZIONE ORIZZONTALE FINESTRA / PORTAFINESTRA 3 ANTE

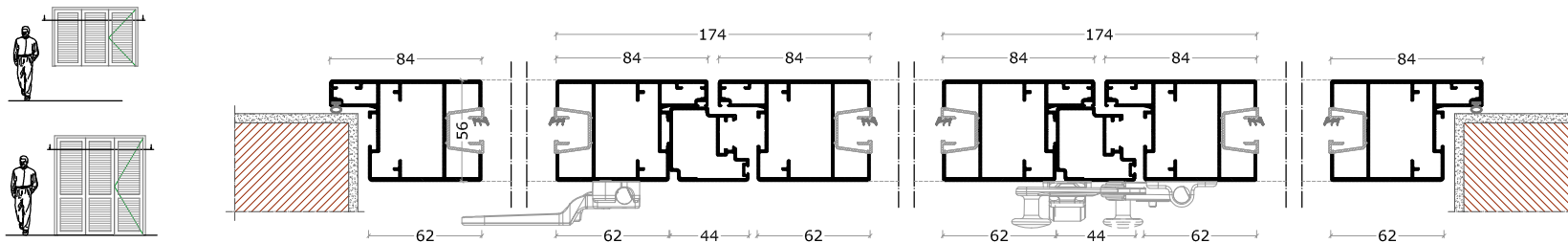

SEZIONE VERTICALE

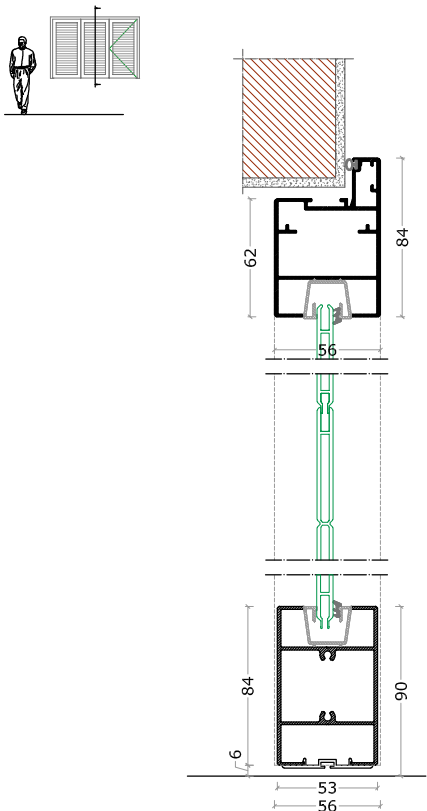

Traverso Inferiore

SEZIONE VERTICALE PortaFinestra

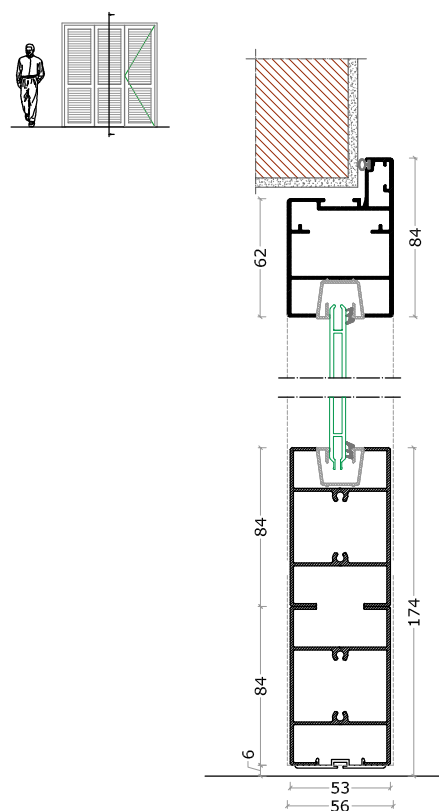

Traverso Inferiore
+1 zoccolo aggiuntivo

TRAVERSO ROMPITRATTA

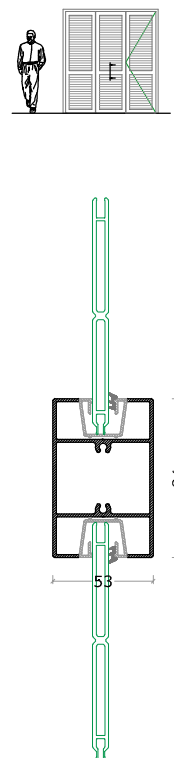

PARTICOLARI LAMELLA

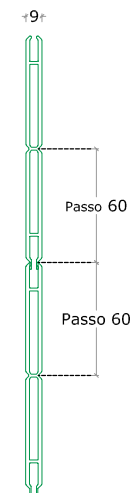

NOTE:

In base alle esigenze del cliente, le doghe possono essere sia in senso verticale, che in senso orizzontale.

SEZIONE ORIZZONTALE FINESTRA / PORTAFINESTRA 4 ANTE

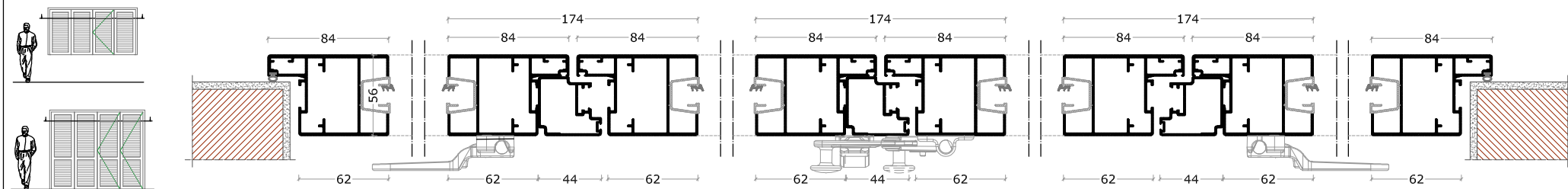

SEZIONE VERTICALE

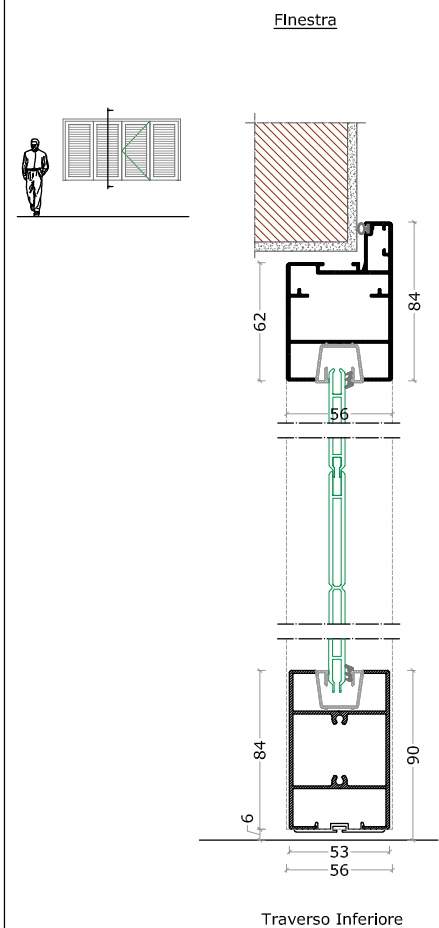

SEZIONE VERTICALE

PortaFinestra

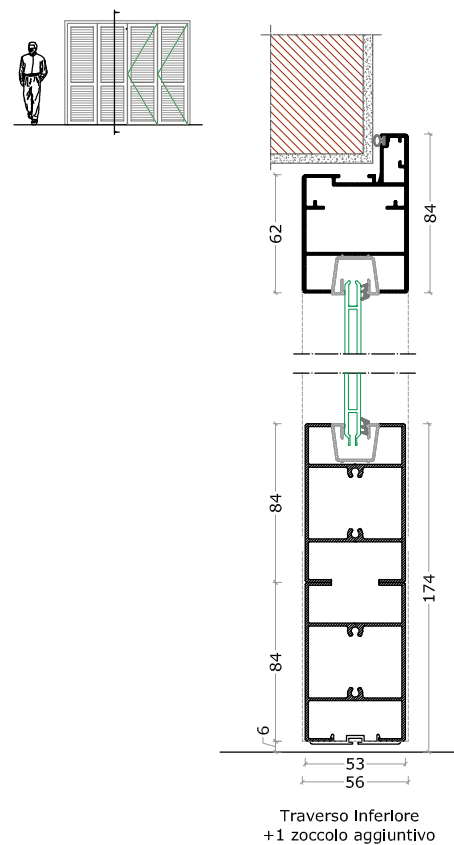

TRAVERSO ROMPIRATTA

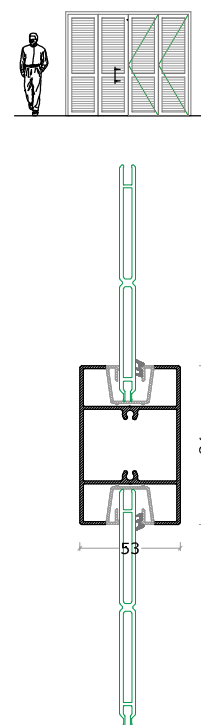

PARTICOLARI LAMELLA

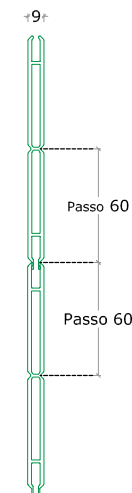

NOTE:

In base alle esigenze del cliente, le doghe possono essere sia in senso verticale, che in senso orizzontale.